

Magnetic Contact

Part No. LC-32

Description

Magnetic contact is a proximity switch what is used magnetic field of magnet to actuate Reed Switch. Because of design in Reed Switch, low cost and simple using-way is major characteristics of magnetic contact.

Application

- Security equipment
- domestic appliances
- automation machines

Feature

- 3/8" Diameter – press fit
- Recessed "shortie" switch set, ideal to thin framed doors and windows
- Longer leads, zip cord or Jacketed cable upon request

Outline dimensions

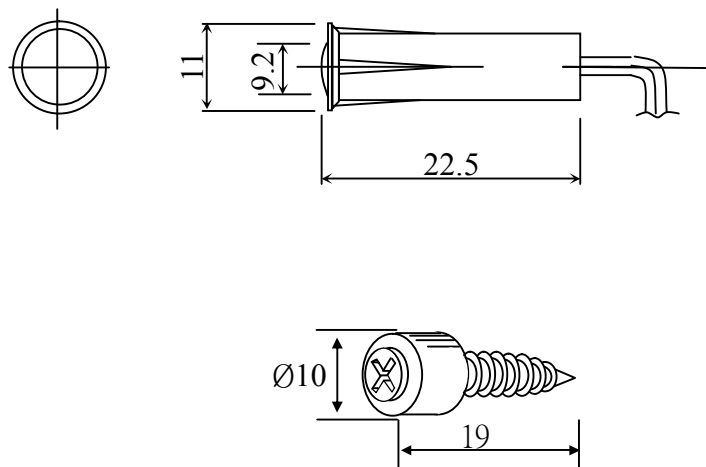

Magnetic Contact

Part No. LC-32

Switch

Contact arrangement	Closed loop
Switching voltage (Max.)	70v AC/DC
Switching current (Max.)	0.5 A
Contact capacity (Max.)	1 watt
Initial contact (Max.)	0.2 Ohm
Carry current (Max.)	100 mA
Breakdown voltage	150 VDC
Insulation resistance (Min.)	100 Mohm
Switch cycle	5×10^7 cycle at 30V 0.1ADC

Magnet

Material	NdFeB rare earth
Residual flux density (Br)	11.8~12.5 KGauss
Maximun energy product (BH) (Max.)	33~36 MG.Oe
Curie temperature (Tc)	310°C

Gap

Sense gap (Min.)	22mm
------------------	------

Physical characteristic

Temperature	-20°C ~ +60°C
Vibration	20 G (10~55 HZ)
Shock	30 G (11 msec)
Heat shock	-25°C ~ +65°C (30Min.) (30Min.) 100 cycle
Package drop	Drop height 80 cm
Humidity	80°C 95% RH 72 hrs